

# Multilink<sup>®</sup> Automix

## Placement of glass ceramic restorations (Inlays, onlays, crowns, bridges, posts)

### Restoration

**Pre-treatment of ceramic restorations:**  
According to manufacturer's instructions.  
E.g. IPS Empress: Etch for 60 sec  
IPS e.max CAD/Press: Etch for 20 sec  
with IPS Ceramic etching gel (hydrofluoric acid).  
Follow safety instructions.

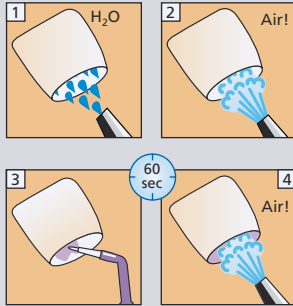

Monobond Plus



### Dentin/Enamel

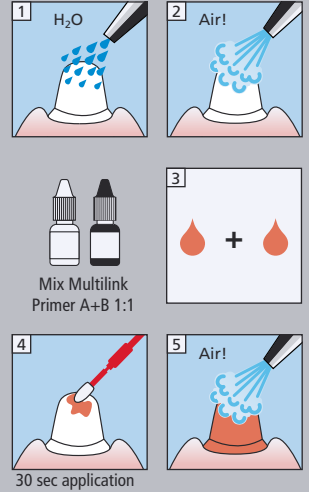

Mix Multilink  
Primer A+B 1:1

30 sec application

Multilink  
Automix

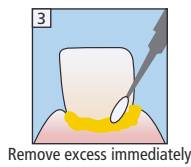
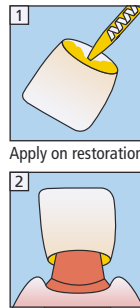

Remove excess immediately

Liquid Strip

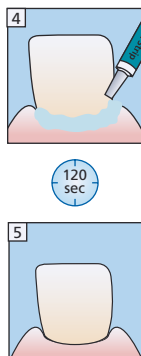

120  
sec

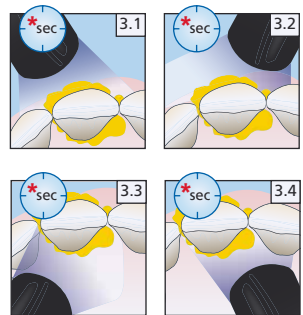

* Light intensity	Exposure time per quarter segment	
<b>Indicated for cases with up to 2 bridge abutments = 3 to 4-unit bridges</b>		
approx. 650 mW/cm <sup>2</sup>	3 sec	e.g. Bluephase in LOW POWER mode
approx. 1.000 mW/cm <sup>2</sup>	1-2 sec	e.g. Bluephase Style or Bluephase in HIGH POWER mode
<b>Indicated for cases with up to 6 bridge abutments = circular bridges</b>		
approx. 650 mW/cm <sup>2</sup>	1 sec	e.g. Bluephase in LOW POWER mode

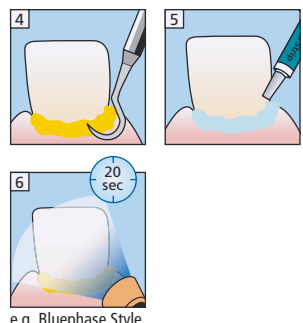

e.g. Bluephase Style

Liquid Strip



# Multilink® Automix

## Befestigung von Glaskeramikrestorationen (Inlays, Onlays, Kronen, Brücken, Wurzelstifte)

### Restauration

**Vorbehandlung von Keramikrestorationen:**  
Gemäss Herstellerangaben.  
z.B. IPS Empress: 60 Sek. ätzen  
IPS e.max CAD/Press: 20 Sek. ätzen  
mit IPS Ceramic-Ätzel (Flusssäure).  
Sicherheitsvorschriften beachten.

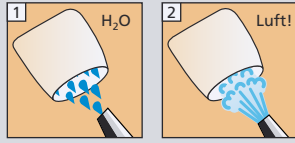

Monobond Plus

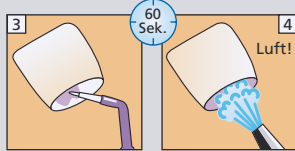

### Dentin/Schmelz

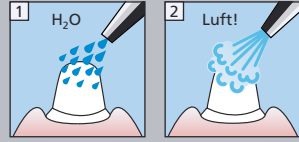

Multilink Primer A+B  
1:1 mischen

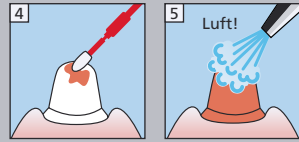
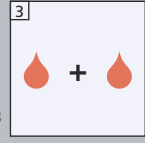

Multilink Automix

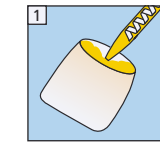

Auf Restauration applizieren

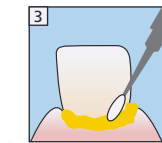
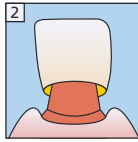

Überschuss sofort entfernen

Liquid Strip

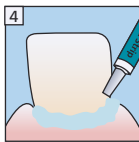

120 Sek.

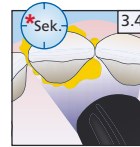
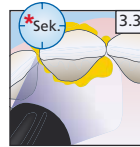
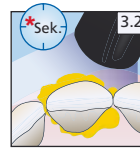
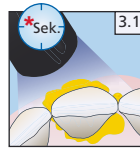
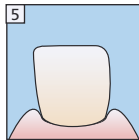

* Lichtintensität	Belichtungszeit pro Viertelseite	
<b>Indikation bis 2 Brückenpfeiler = 3-4 gliedrige Brücke</b>		
ca. 650 mW/cm <sup>2</sup>	3 Sek.	z.B. Bluephase im LOW POWER-Modus
ca. 1.000 mW/cm <sup>2</sup>	1-2 Sek.	z.B. Bluephase Style oder Bluephase im HIGH POWER-Modus
<b>Indikation bis 6 Brückenpfeiler = zirkuläre Brücke</b>		
ca. 650 mW/cm <sup>2</sup>	1 Sek.	z.B. Bluephase im LOW POWER-Modus

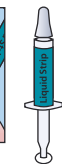
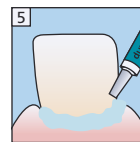
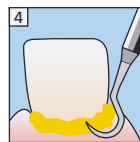

Liquid Strip



z.B. Bluephase Style



mehr Informationen unter  
[www.cementation-navigation.com](http://www.cementation-navigation.com)

CE 0123

ivoclar  
vivadenti  
clinical